

# Bain Signature

7300 Rue Sherbrooke O,  
Montréal, QC H4B 1R7  
www.bainsignature.com

**Model Modèle: JULIET**

Freestanding bathtub

Baignoire autoportante

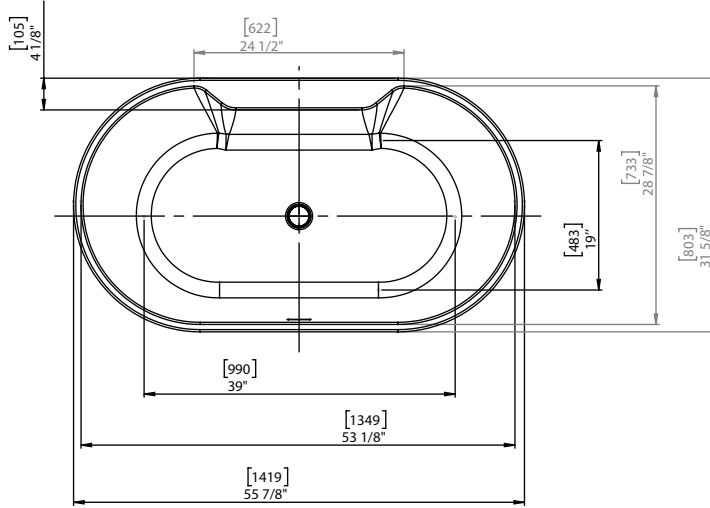

TOP VIEW VUE DE DESSUS

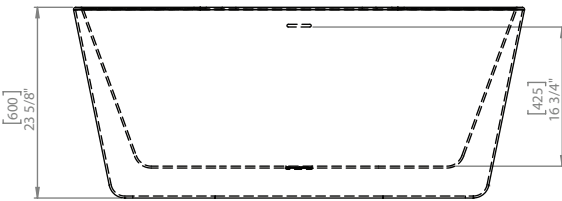

FRONT VIEW VUE DE FACE

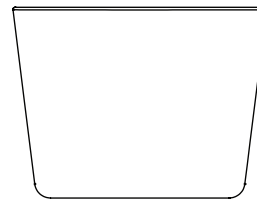

SIDE VIEW VUE DE CÔTÉ

\* Dimensions may vary +/- 1/4" (6mm) / Les dimensions peuvent varier de +/- 1/4" (6mm)

gallons to overflow / gallon au trop plein	63 gal.
packaging dimension / d'emballage	59 x 35 x 27 in
approximated weight / Poids approximatif	110 lbs
weight with water / poids rempli d'eau	636 lbs
bathing well at sump / dimension interieur au rebord	39 x 19 in
bathing well at rim / dimension au bord du bain	53 x 29 in

## Compliance Certifications:

Uniform Plumbing Code  
National Plumbing Code of Canada  
CSA B45.5-17/IAPMO Z124-2017



Pure acrylic construction reinforced by fiberglass  
Construction en acrylique renforcée de fibre de verre

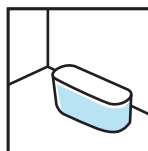

Freestanding installation  
Installation autoportante

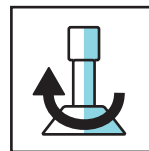

Adjustable feet  
Pattes ajustables

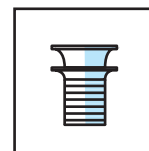

Chrome drain included  
Drain chrome inclus

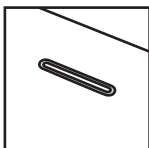

Integrated chrome linear overflow  
Trop plein linéaire chrome intégré



CUPC certified  
Certifié CUPC